

FRD – ROUND FLOOR DIFFUSERS



Description

- Designed for air supply in the ventilation and air-conditioning installations, where floor type air delivery is required.

Construction

- The diffuser consists of decorative part and cylinder made of perforated metal sheet with regulation unit at the bottom. Decorative part is constructed of galvanized metal sheet with movable internal section. Air flow regulation and cleaning of the diffuser is provided with it.
- Designed to bear up human's body weight.

Installation

- Diffusers are installed with plenum box. It is necessary to provide possibility for cleaning and draining.

Overall and joined dimensions

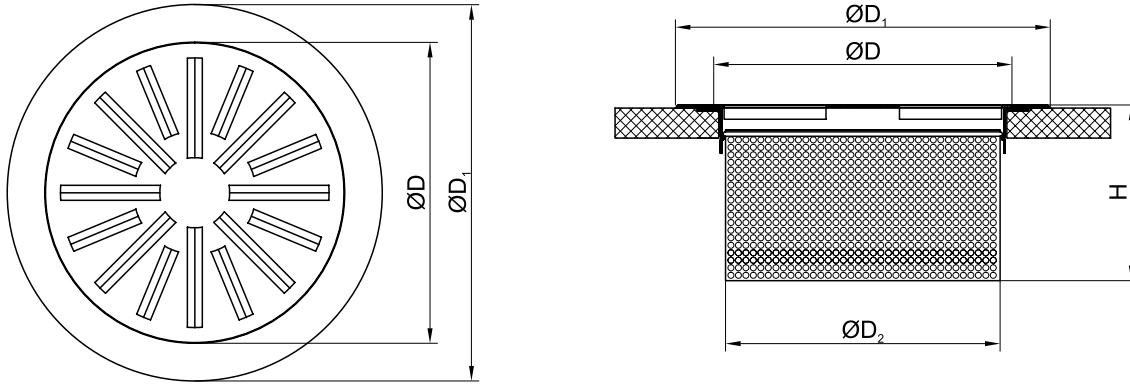

Model	ØD	ØD	ØD	H
150	149	200	183	120
200	199	250	233	170

Pressure drop ΔP [Pa] and noise levels L [dB(A)]

Model		Air flow V [m ³ /h]	20	50	70	100	150	200
150	100% open	ΔP [Pa]	-	9	17	35	-	-
		L [dB(A)]	-	15	25	35	-	-
	50% open	ΔP [Pa]	6	40	60	-	-	-
		L [dB(A)]	10	37	45	-	-	-
200	100% open	ΔP [Pa]	-	-	-	13	30	55
		L [dB(A)]	-	-	-	23	33	40
	50% open	ΔP [Pa]	-	10	15	30	90	100
		L [dB(A)]	-	15	24	33	48	50

Air velocity W [m/s]

Model	Air flow V [m ³ /h]	20	50	70	100	150	200
	150		0.1	0.25	0.34	0.45	-
200		-	0.12	0.18	0.22	0.28	0.4

Note: The data above is valid for distance 1,30 m from the diffuser and $\Delta T = 0^\circ K$

Order designation

